

Application to vary a premises licence under the Licensing Act 2003

PLEASE READ THE FOLLOWING INSTRUCTIONS FIRST

Before completing this form please read the guidance notes at the end of the form. If you are completing this form by hand please write legibly in block capitals. In all cases ensure that your answers are inside the boxes and written in black ink. Use additional sheets if necessary.

You may wish to keep a copy of the completed form for your records.

I/We Adelle Gill
(Insert name(s) of applicant)

being the premises licence holder, apply to vary a premises licence under section 34 of the Licensing Act 2003 for the premises described in Part 1 below

Premises licence number	LN LN000010557
-------------------------	---------------------------

Part 1 - Premises Details

Postal address of premises or, if none, ordnance survey map reference or description	<u>The white hart Lane end.</u> <u>BA12 7PH</u>
--	--

Post town	<u>BA12 7PH warminster</u>	Postcode	<u>BA12 7PH</u>
-----------	----------------------------	----------	-----------------

Telephone number at premises (if any)	
Non-domestic rateable value of premises	£ <u>Band B</u>

Part 2 - Applicant details

Daytime contact telephone number			
E-mail address (optional)			
Current postal address if different from premises address		<u>AS above.</u>	
Post town		Postcode	

Part 3 - Variation



Please tick as appropriate

Do you want the proposed variation to have effect as soon as possible?

Yes

No

If not, from what date do you want the variation to take effect?

DD	MM	YYYY

Please describe briefly the nature of the proposed variation (Please see guidance note 1)

Extend hours for alcohol sales
+ opening hours.
Alcohol from 10am - 12am. midnight.
New Years eve hours.
ADD recorded music.
ADD off sales.
ADD late night refreshment.
Live music till midnight.

If your proposed variation would mean that 5,000 or more people are expected to attend the premises at any one time, please state the number expected to attend:

--

Part 4 Operating Schedule

Please complete those parts of the Operating Schedule below which would be subject to change if this application to vary is successful.

Provision of regulated entertainment

Please tick all that apply

- a) plays (if ticking yes, fill in box A)
- b) films (if ticking yes, fill in box B)
- c) indoor sporting events (if ticking yes, fill in box C)
- d) boxing or wrestling entertainment (if ticking yes, fill in box D)
- e) live music (if ticking yes, fill in box E)
- f) recorded music (if ticking yes, fill in box F)
- g) performances of dance (if ticking yes, fill in box G)
- h) anything of a similar description to that falling within (e), (f) or (g) (if ticking yes, fill in box H)

Provision of late night refreshment (if ticking yes, fill in box I)



Sale by retail of alcohol (if ticking yes, fill in box J)



In all cases complete boxes K, L and M

A

Plays Standard days and timings (please read guidance note 6)			Will the performance of a play take place indoors or outdoors or both – please tick (please read guidance note 2)	Indoors	<input type="checkbox"/>
				Outdoors	<input type="checkbox"/>
				Both	<input type="checkbox"/>
Day	Start	Finish	Please give further details here (please read guidance note 3)		
Mon					
Tue			State any seasonal variations for performing plays (please read guidance note 4)		
Wed					
Thur			Non standard timings. Where you intend to use the premises for the performance of plays at different times to those listed in the column on the left, please list (please read guidance note 5)		
Fri					
Sat					
Sun					

B

Films Standard days and timings (please read guidance note 6)			<u>Will the exhibition of films take place indoors or outdoors or both – please tick (please read guidance note 2)</u>	
			Indoors	<input type="checkbox"/>
			Outdoors	<input type="checkbox"/>
Day	Start	Finish	Both <input type="checkbox"/>	
Mon			<u>Please give further details here (please read guidance note 3)</u>	
Tue			<u>State any seasonal variations for the exhibition of films (please read guidance note 4)</u>	
Wed			<u>Non standard timings. Where you intend to use the premises for the exhibition of films at different times to those listed in the column on the left, please list (please read guidance note 5)</u>	
Thur				
Fri				
Sat				
Sun				

C

Indoor sporting events Standard days and timings (please read guidance note 6)			Please give further details (please read guidance note 3)
Day	Start	Finish	
Mon			
Tue			State any seasonal variations for indoor sporting events (please read guidance note 4)
Wed			
Thur			Non standard timings. Where you intend to use the premises for indoor sporting events at different times to those listed in the column on the left, please list (please read guidance note 5)
Fri			
Sat			
Sun			

D

Boxing or wrestling entertainments Standard days and timings (please read guidance note 6)			Will the boxing or wrestling entertainment take place indoors or outdoors or both – please tick (please read guidance note 2)	Indoors	<input type="checkbox"/>
				Outdoors	<input type="checkbox"/>
Day	Start	Finish		Both	<input type="checkbox"/>
Mon			Please give further details here (please read guidance note 3)		
Tue					
Wed			State any seasonal variations for boxing or wrestling entertainment (please read guidance note 4)		
Thur					
Fri			Non standard timings. Where you intend to use the premises for boxing or wrestling entertainment at different times to those listed in the column on the left, please list (please read guidance note 5)		
Sat					
Sun					

E

Live music Standard days and timings (please read guidance note 6)			Will the performance of live music take place indoors or outdoors or both – please tick (please read guidance note 2)	Indoors	<input checked="" type="checkbox"/>
Day	Start	Finish		Outdoors	<input type="checkbox"/>
Mon	5	11.00 00	Please give further details here (please read guidance note 3)	Both	<input type="checkbox"/>
Tue	5	00.00			
Wed	5	00.00	State any seasonal variations for the performance of live music (please read guidance note 4)		
Thur	5	00.00			
Fri	5	00.00	Non standard timings. Where you intend to use the premises for the performance of live music at different times to those listed in the column on the left, please list (please read guidance note 5)		
Sat	5.00	00.00		Bank holiday 1pm - 00.00	
Sun	5.00	00.00		New years eve from the permitted hours - until permitted hours following day	

F

Recorded music Standard days and timings (please read guidance note 6)			Will the playing of recorded music take place indoors or outdoors or both – please tick (please read guidance note 2)	Indoors	<input checked="" type="checkbox"/>
				Outdoors	<input type="checkbox"/>
				Both	<input type="checkbox"/>
Day	Start	Finish			
Mon	8.30	00.00	Please give further details here (please read guidance note 3)		
Tue	8.30	00.00			
Wed	8.30	00.00	State any seasonal variations for the playing of recorded music (please read guidance note 4)		
Thur	8.30	00.00			
Fri	8.30	00.00	Non standard timings. Where you intend to use the premises for the playing of recorded music at different times to those listed in the column on the left, please list (please read guidance note 5)		
Sat	8.30	00.00			
Sun	8.30	00.00			

Bank Holiday
New Year eve from the end
permitted hours until the ~~end~~ begin
of the following permitted hours.

G

Performances of dance Standard days and timings (please read guidance note 6)			Will the performance of dance take place indoors or outdoors or both – please tick (please read guidance note 2)	Indoors	<input type="checkbox"/>
Day	Start	Finish		Outdoors	<input type="checkbox"/>
				Both	<input type="checkbox"/>
Mon			Please give further details here (please read guidance note 3)		
Tue					
Wed			State any seasonal variations for the performance of dance (please read guidance note 4)		
Thur					
Fri			Non standard timings. Where you intend to use the premises for the performance of dance at different times to those listed in the column on the left, please list (please read guidance note 5)	New Year's eve 8-00-00.	
Sat					
Sun					

H

<p>Anything of a similar description to that falling within (e), (f) or (g) Standard days and timings (please read guidance note 6)</p>			<p>Please give a description of the type of entertainment you will be providing</p>		
Day	Start	Finish	<p><u>Will this entertainment take place indoors or outdoors or both – please tick</u> (please read guidance note 2)</p>	Indoors	<input type="checkbox"/>
Mon				Outdoors	<input type="checkbox"/>
				Both	<input type="checkbox"/>
Tue			<p><u>Please give further details here</u> (please read guidance note 3)</p>		
Wed					
Thur			<p><u>State any seasonal variations for entertainment of a similar description to that falling within (e), (f) or (g)</u> (please read guidance note 4)</p>		
Fri					
Sat			<p><u>Non standard timings. Where you intend to use the premises for the entertainment of a similar description to that falling within (e), (f) or (g) at different times to those listed in the column on the left, please list</u> (please read guidance note 5)</p>		
Sun					

Late night refreshment Standard days and timings (please read guidance note 6)			Will the provision of late night refreshment take <u>place indoors or outdoors or both</u> – please tick (please read guidance note 2)	Indoors	<input type="checkbox"/>
Day	Start	Finish		Outdoors	<input type="checkbox"/>
Mon	23.00	00.00	Please give further details here (please read guidance note 3) Take away service	Both	<input checked="" type="checkbox"/>
Tue					
Wed			State any seasonal variations for the provision of late night refreshment (please read guidance note 4)		
Thur					
Fri			Non standard timings. Where you intend to use the premises for the provision of late night refreshment at different times, to those listed in the column on the left, please list (please read guidance note 5)		
Sat					
Sun					

J

Supply of alcohol Standard days and timings (please read guidance note 6)			Will the supply of alcohol be for consumption – please tick (please read guidance note 7)	On the premises	<input type="checkbox"/>
				Off the premises	<input type="checkbox"/>
Day	Start	Finish		Both	<input checked="" type="checkbox"/>
Mon	10.00	00.00	State any seasonal variations for the supply of alcohol (please read guidance note 4)		
Tue					
Wed					
Thur			Non-standard timings. Where you intend to use the premises for the supply of alcohol at different times to those listed in the column on the left, please list (please read guidance note 5)		
Fri					
Sat					
Sun					

K

Please highlight any adult entertainment or services, activities, other entertainment or matters ancillary to the use of the premises that may give rise to concern in respect of children (please read guidance note 8).

None.

Hours premises are open to the public Standard days and timings (please read guidance note 6)			State any seasonal variations (please read guidance note 4)
Day	Start	Finish	
Mon	8.30	00.30	<p>Non standard timings. Where you intend the premises to be open to the public at different times from those listed in the column on the left, please list (please read guidance note 5)</p> <p>New year's eve. From permitted hours until the beginning of the next permitted day.</p>
Tue			
Wed			
Thur			
Fri			
Sat			
Sun			

Please identify those conditions currently imposed on the licence which you believe could be removed as a consequence of the proposed variation you are seeking.

M

Describe any additional steps you intend to take to promote the four licensing objectives as a result of the proposed variation:

a) General – all four licensing objectives (b, c, d and e) (please read guidance note 9)

b) The prevention of crime and disorder

c) Public safety

d) The prevention of public nuisance

e) The protection of children from harm

Checklist:

Please tick to indicate agreement

- I have made or enclosed payment of the fee.
- I have sent copies of this application and the plan to responsible authorities and others where applicable.
- I understand that I must now advertise my application.
- I have enclosed the premises licence or relevant part of it or explanation.
- I understand that if I do not comply with the above requirements my application will be rejected.

IT IS AN OFFENCE, LIABLE ON SUMMARY CONVICTION TO A FINE NOT EXCEEDING LEVEL 5 ON THE STANDARD SCALE, UNDER SECTION 158 OF THE LICENSING ACT 2003, TO MAKE A FALSE STATEMENT IN OR IN CONNECTION WITH THIS APPLICATION.

Part 5 – Signatures (please read guidance note 10)

Signature of applicant (the current premises licence holder) or applicant's solicitor or other duly authorised agent (please read guidance note 11). If signing on behalf of the applicant, please state in what capacity.

Signature	
Date	
Capacity	

Where the premises licence is jointly held, signature of 2nd applicant (the current premises licence holder) or 2nd applicant's solicitor or other authorised agent (please read guidance note 12). If signing on behalf of the applicant, please state in what capacity.

Signature	
Date	
Capacity	

Contact name (where not previously given) and address for correspondence associated with this application (please read guidance note 13)

Contact name (where not previously given) and address for correspondence associated with this application (please read guidance note 13)			
Post town		Post code	
Telephone number (if any)			
If you would prefer us to correspond with you by e-mail, your e-mail address (optional)			

Checklist:

- I have made or enclosed payment of the fee; or Please tick to indicate agreement
- I have not made or enclosed payment of the fee because this application has been made in relation to the introduction of the late night levy.
- I have sent copies of this application and the plan to responsible authorities and others where applicable.
- I understand that I must now advertise my application.
- I have enclosed the premises licence or relevant part of it or explanation.
- I understand that if I do not comply with the above requirements my application will be rejected.

IT IS AN OFFENCE, UNDER SECTION 158 OF THE LICENSING ACT 2003, TO MAKE A FALSE STATEMENT IN OR IN CONNECTION WITH THIS APPLICATION. THOSE WHO MAKE A FALSE STATEMENT MAY BE LIABLE ON SUMMARY CONVICTION TO A FINE OF ANY AMOUNT.

Part 5 – Signatures (please read guidance note 12)

Signature of applicant (the current premises licence holder) or applicant's solicitor or other duly authorised agent (please read guidance note 13). If signing on behalf of the applicant, please state in what capacity.

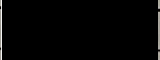
Signature	
Date	11 June 2020
Capacity	

Where the premises licence is jointly held, signature of 2nd applicant (the current premises licence holder) or 2nd applicant's solicitor or other authorised agent (please read guidance note 14). If signing on behalf of the applicant, please state in what capacity.

Signature	
Date	
Capacity	

Contact name (where not previously given) and address for correspondence associated with this application (please read guidance note 15)

Post town		Post code	
Telephone number (if any)			

The White Hart, Lane End, Corsley, Warminster, BA12 7PH

Approximate Gross Internal Area :- 296 sq m / 3183 sq ft

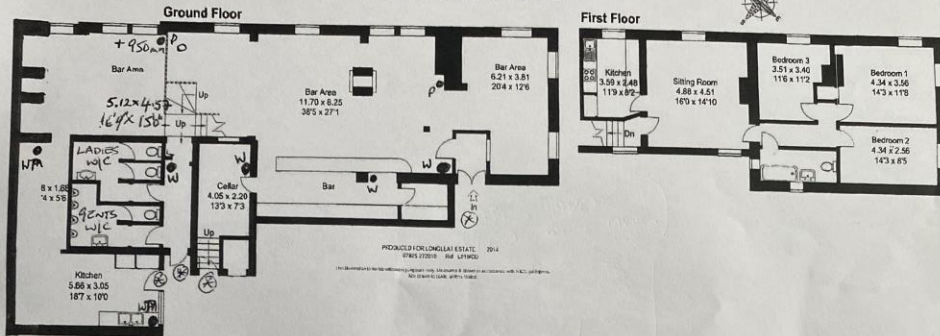

- ⊗ ESCAPE DOORS.
- FIRE EXTINGUISHERS.
- P = POWDER
- W = WATER
- W/M = WATER MIST

